

Cold Applied Systems

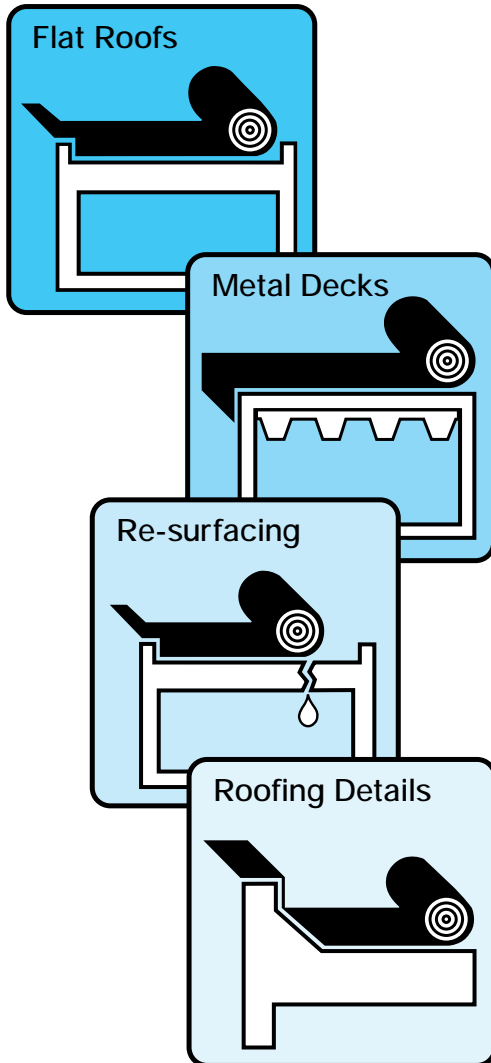

**BITEC
Brings You
The Ideal
Roofing System
For Low Slope
Roofs on
Houses,
Carports,
and Small
Commercial
Buildings**

BITEC
BITUMEN TECHNOLOGY

MANUFACTURERS OF ADVANCED TECHNOLOGY WATERPROOFING MEMBRANES

Strong and Long Lasting

INTRODUCTION

BITEC's cold adhesive-applied SBS modified bitumen membranes give you better security and performance than conventional roll roofing products made with oxidized asphalt. Their application range covers a variety of slopes and deck configurations. From ¼" in 12" up to 3" in 12", the membrane is functional. Another advantage is that hot asphalt and open flame are not required for installation. This reduces the potential for fire.

A special-formulated cold adhesive is used to install the membrane. After a short curing time the cold adhesive applied system forms a flexible, durable, watertight system that will outlast conventional roofing systems.

PRODUCTS

BITEC SBS modified bitumen membranes SPM-3.5H and SFM-3.5H are recommended for use by this method. However, any BITEC sand surfaced SBS modified bitumen

product can be installed using cold applied adhesives. (See back for more product listings.) These membranes are tear and puncture resistant, have excellent flexibility and performance as opposed to conventional organic and fiberglass reinforced blown asphalt coated membranes.

BITEC SBS modified bitumen membranes are composed of distilled asphalt modified with SBS thermoplastic rubber. A high strength fiberglass or polyester reinforcement is used as support.

ADHESIVES

BITEC PMA 186 field grade SBS modified bitumen adhesive is recommended for use on low slope applications, while PMA 2000, trowel grade SBS modified bitumen adhesive is recommended for all flashings and higher slope applications.

Both adhesives contain

an SBS thermoplastic rubber as a modifier, ensuring complete compatibility between the cap sheet and the adhesive.

- Performs Better than Conventional Roll Roofing
- No Hot Asphalt or Open Flame Required
- Excellent Tear and Puncture Resistance
- Easy to Apply, Easy to Maintain
- Excellent Cold Flexibility

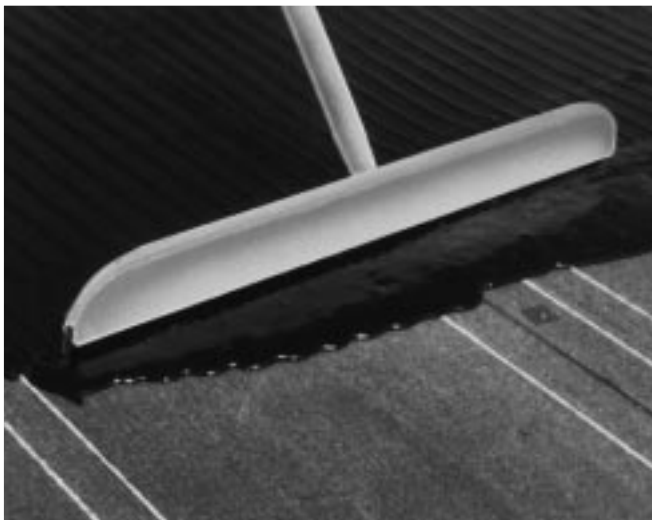

Easy Application...

General Requirements

Follow all good roofing practices, and BITEC specifications when installing adhesive applied membranes.

Base sheet and insulation must be mechanically attached to deck.

Use only BITEC SBS modified bitumen membranes having sand on the bottom surface

and granules on the top surface. (SPM3.5H or SFM-3.5H).

Adhesive may be applied at temperatures between 55° F and 120° F.

Only BITEC approved adhesives should be used to install these membranes.

Follow the adhesive manufacturer's application rates when installing these membranes.

Typically application rates will be 1½ gallons per 100 ft².

Apply adhesive by notched squeegee with notches ¼" long, ⅛" deep and spaced 1" on center, or by using a three knot brush or notched trowel.

Deck should be built with ½" min. plywood or ¾" min. wood boards. Deck shall be dry, smooth and free of debris.

Deck should be built to provide ¼" in 12" minimum slope.

Base sheet should be UL Listed Type G2 and or 43# organic. Base sheet must be attached using suitable fasteners (i.e. Simplex nails) 9" on the laps and stagger nailed 18" o.c. in the field.

Flashing material shall be the same material used for field membrane.

Slopes above ¾" in 12" require blind nailing the membrane using suitable fasteners (i.e. Simplex nails) at intervals of 8" to 9" o.c.

PHYSICAL PROPERTIES & SPECIFICATIONS BITEC vs a Typical 90# Product

	BITEC SPM-3.5H	BITEC SFM-3.5H	Typical 90# Roll Roofing
Tensile MD* (lbf/2")	210	160	100
Elongation*	60%	30%	6%
Thickness	.140 in	.140 in	.135 in
Cold Flexibility	-13°F	-13°F	70°F

All values shown are approximate *ASTM D412 / sample 2" wide

INSTALLATION

The adhesive should be applied using a notched squeegee, brush or trowel, following the guidelines and application rates set forth in BITEC technical publications relative to cold adhesive application.

Special care should be taken not to over-apply the adhesive. Over-application can cause degradation of the membrane.

Positive drainage should always be provided in order to prevent ponding water.

Never install more than one ply of membrane in adhesive. Multi-ply application is not recommended.

A typical system would be composed of a nailed UL Listed G2 fiberglass reinforced base sheet, with the adhesive-applied BITEC cap sheet installed as the finished surface.

For warranty information governing cold adhesive applied membrane products, contact BITEC's Manager of Technical Services.

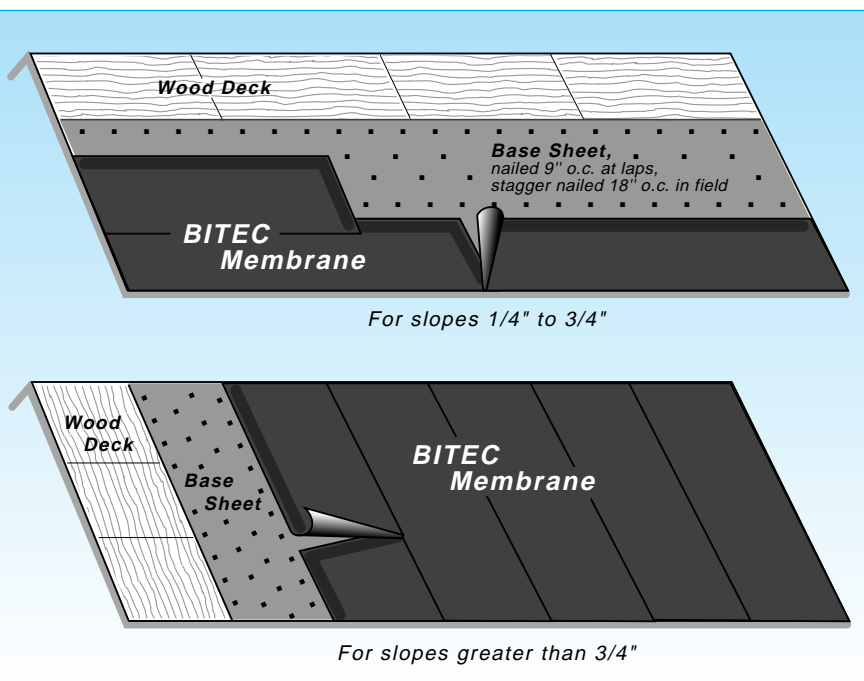

PARAPET WALL DETAIL

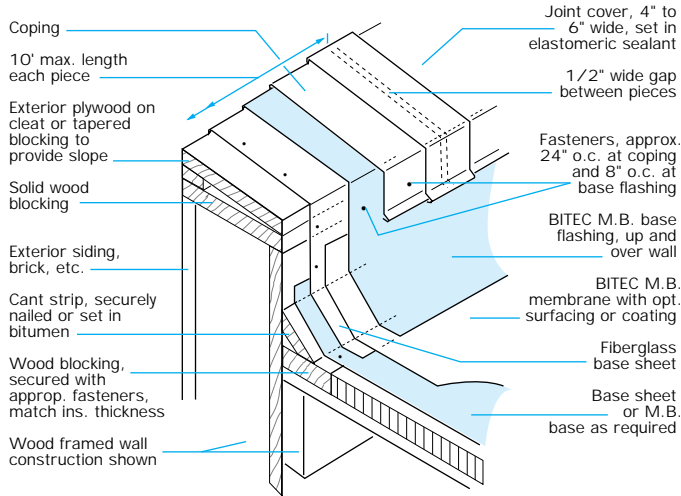

EDGE DETAIL

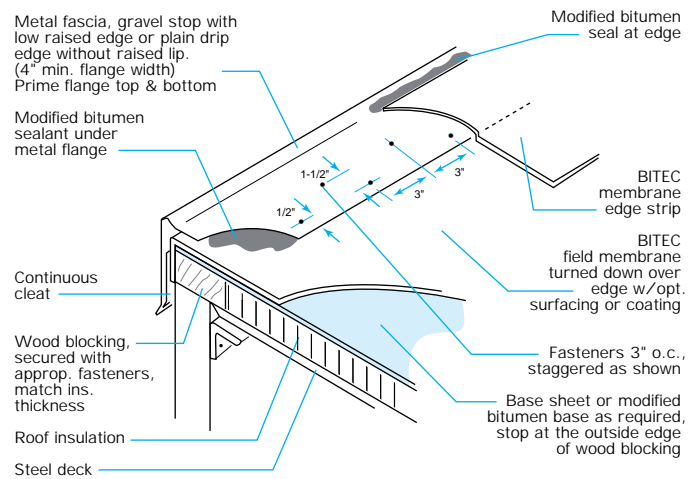

ROOF DRAIN DETAIL

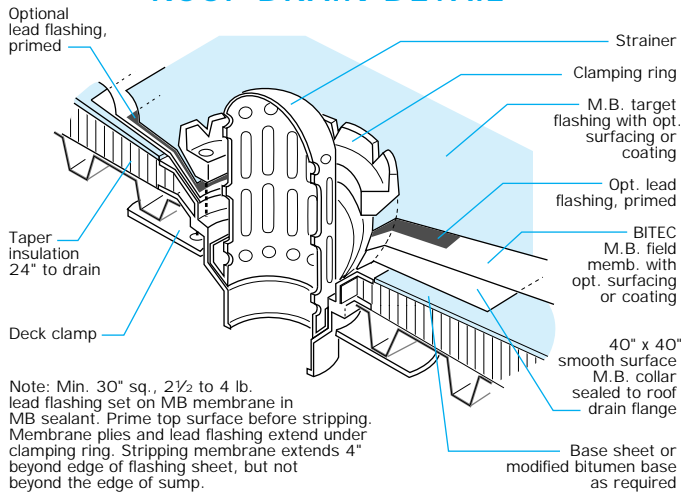

VENT PIPE DETAIL

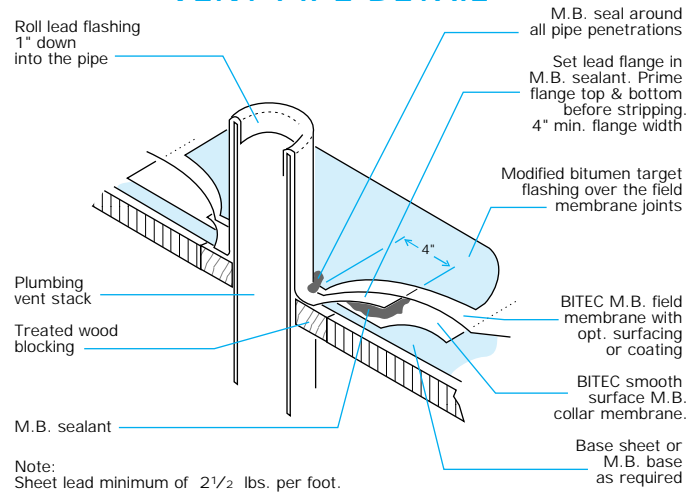

"We've Got the Highest Technology to Stop the Smallest Leak"

BITEC
BITUMEN TECHNOLOGY

MANUFACTURERS OF ADVANCED TECHNOLOGY WATERPROOFING MEMBRANES

P.O. Box 497 • #2 Industrial Park Dr. • Morrilton, Arkansas 72110 • Fax (501) 354-3019 • Phone 1-800-535-8597